

# THE INSTALLATION OF ECOHEADS SHOWER HEAD

Follow these easy steps for a quick installation.

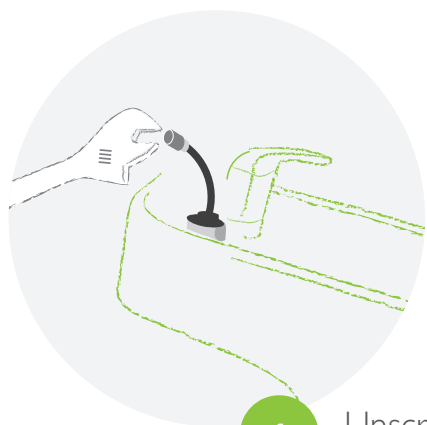

1 Unscrew the existing shower head

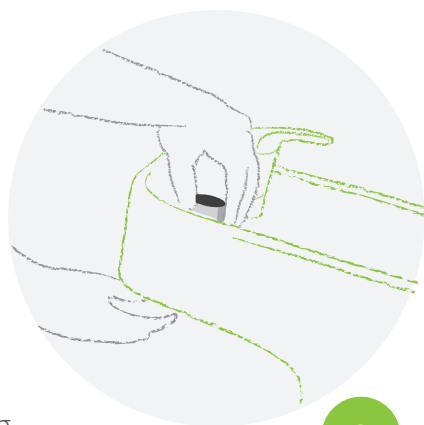

2 Unscrew existing base\*

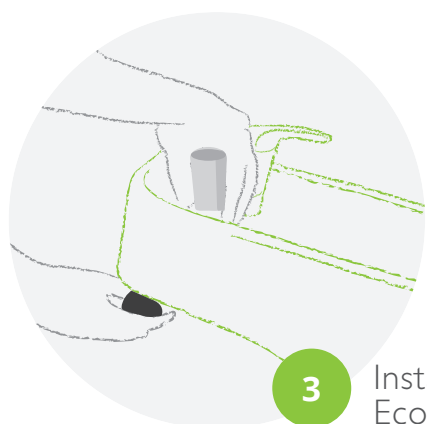

3 Install EcoHeads base



4 Identify your hose fitting.

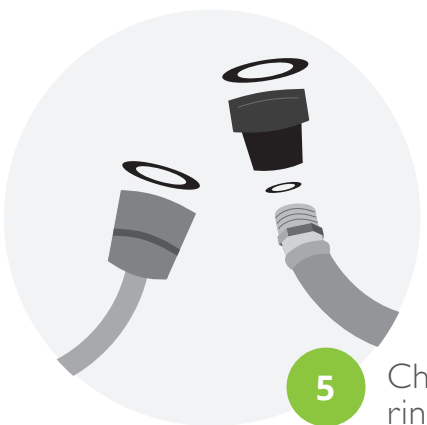

5 Check rubber rings are in place



6 Screw on the EcoHead

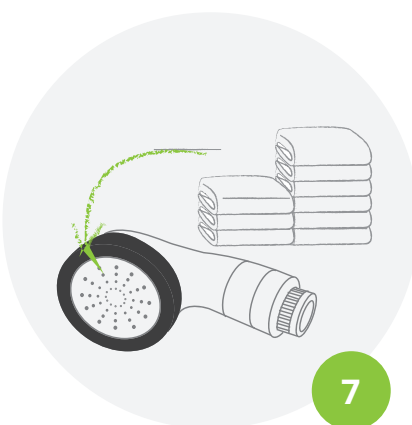

7 Before the first use, wipe the plate with a dry & clean towel

Watch the video: [www.ecoheads.com.au/shower-head](http://www.ecoheads.com.au/shower-head)

\* (2) You can use the existing shower head to unscrew the existing base.

\*\* (2) If the base is stuck or rusted, we recommend contacting your plumber.

Please follow the installation process exactly as shown above or on the installation video. Any other method is the responsibility of the installer and may cause loss of warranty.

ECOHEADS™

Unique Products That  
Make A Difference